

# Emax - Tmax

DOC. N.° 1SDH000529R0621 - L3015

Motoriduttore per la carica automatica delle molle di chiusura T7M-X1

Gearmotor for automatic loading of closing springs T7M-X1

Getriebemotor zum automatischen Spannen der Einschaltfedern T7M-X1

Motoréducteur pour le bandage automatique des ressorts de fermeture T7M-X1

Motorreductor para la carga automática de los muelles de cierre T7M-X1

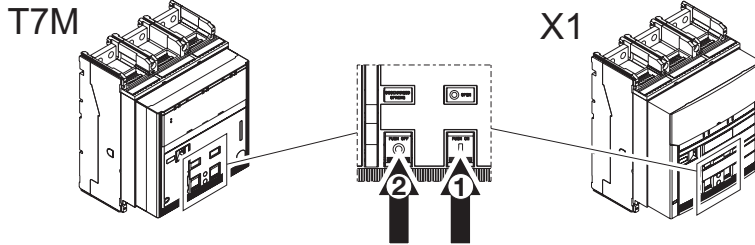

OPTIONAL FOR W

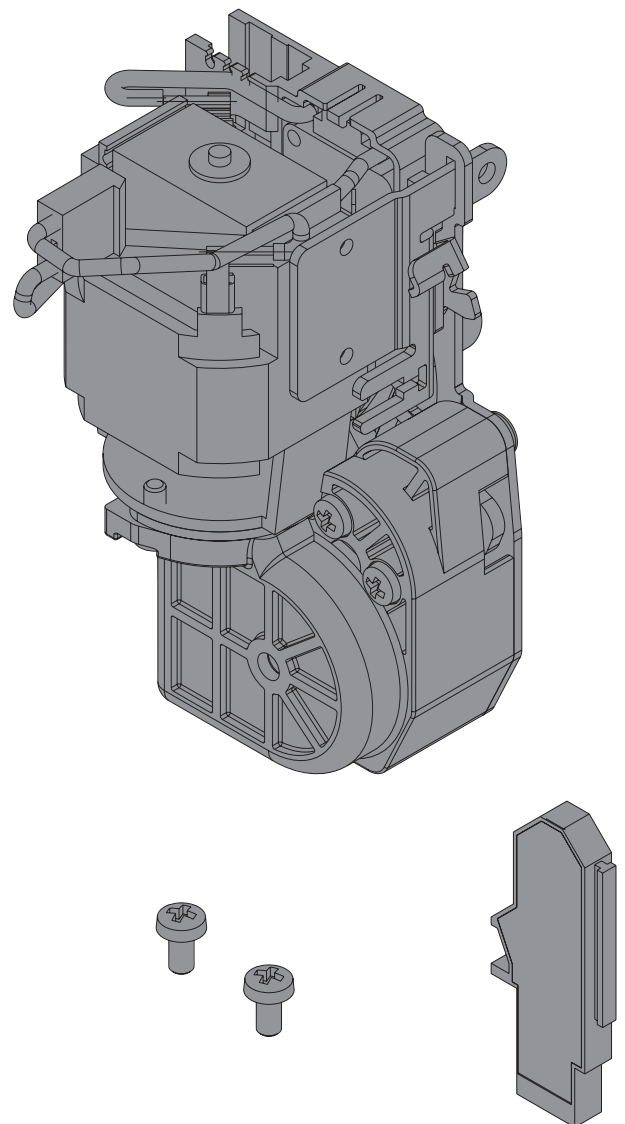
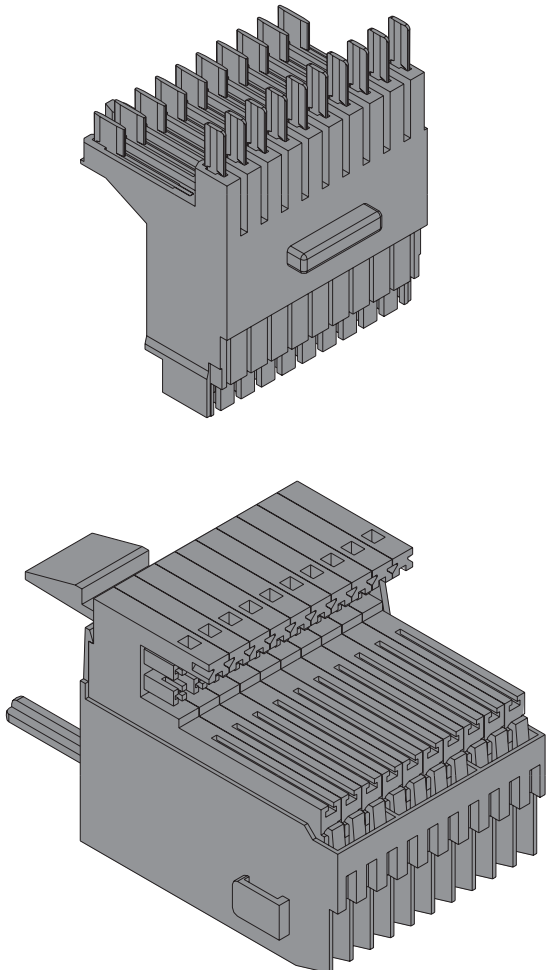

A

T7M-X1

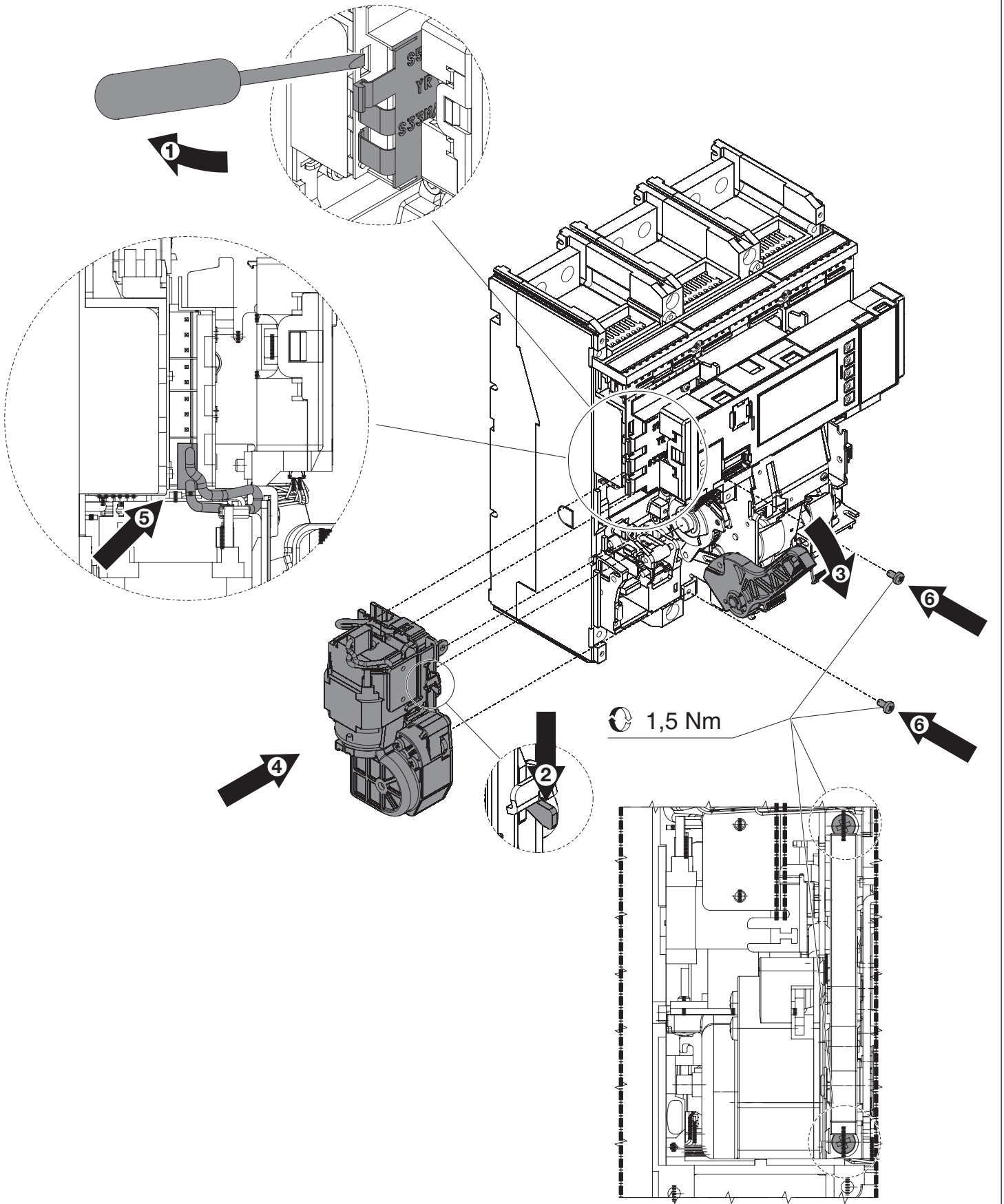

**ABB**

**B** T7M-X1

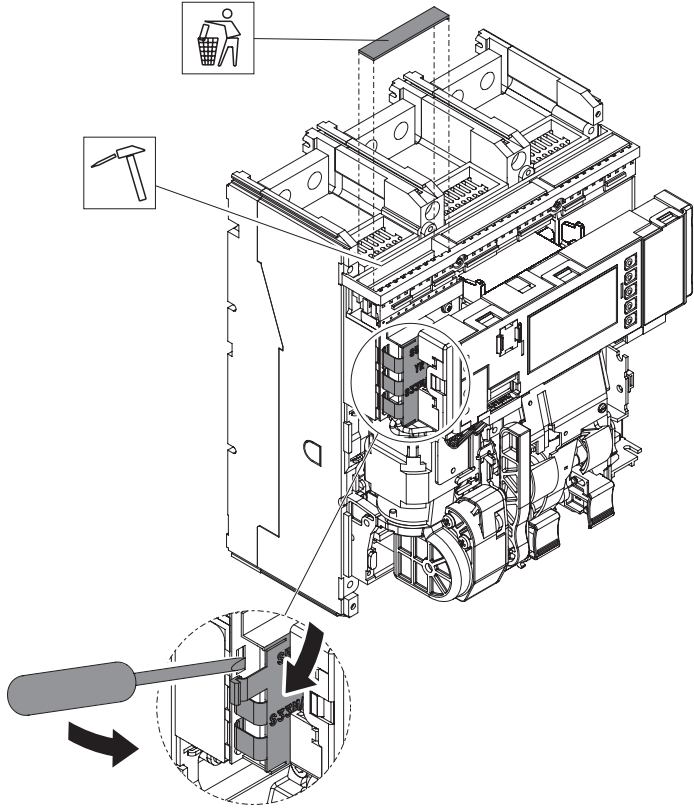

**C** T7M-X1

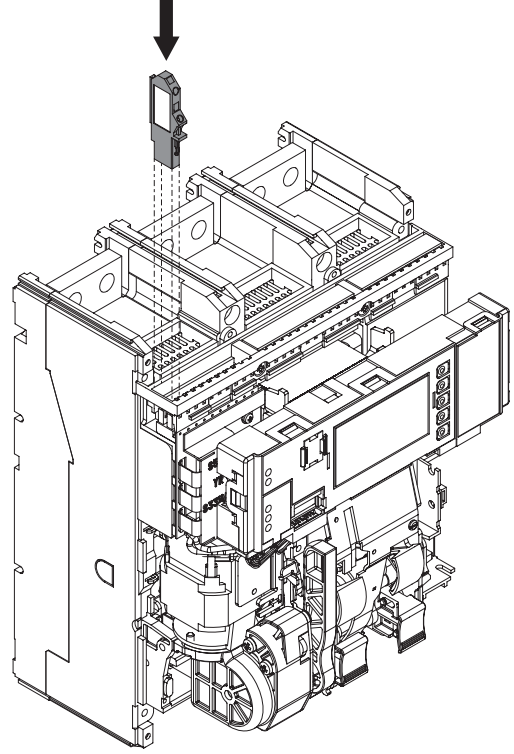

**D** T7M

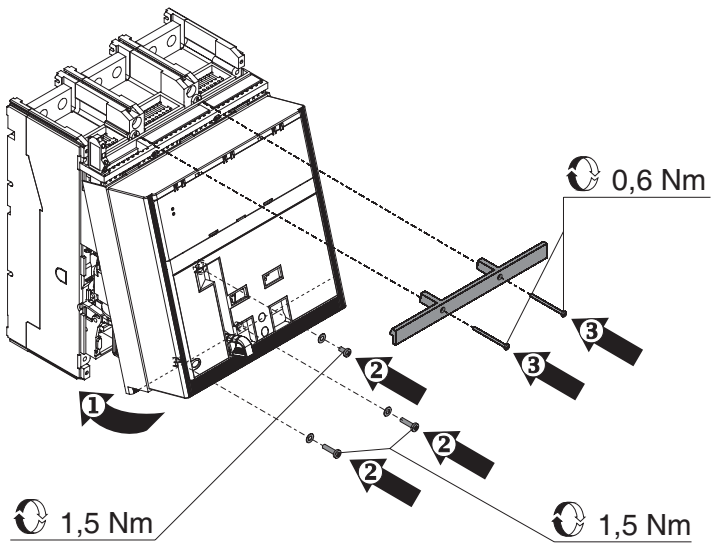

**E** X1

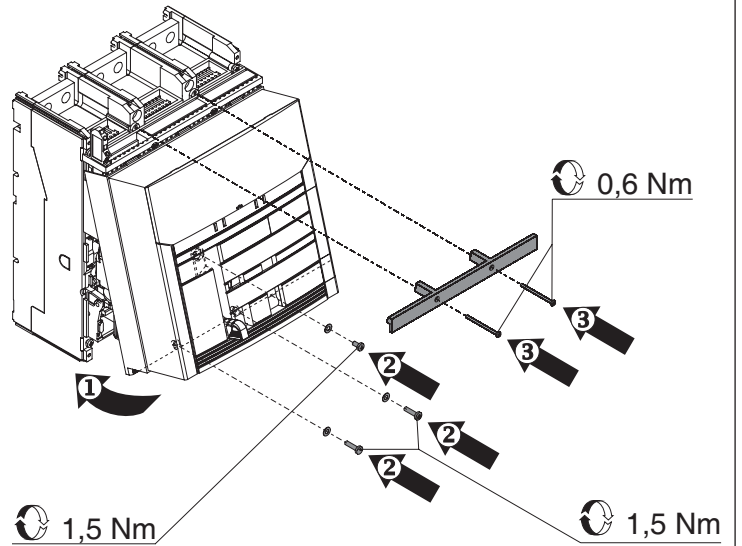

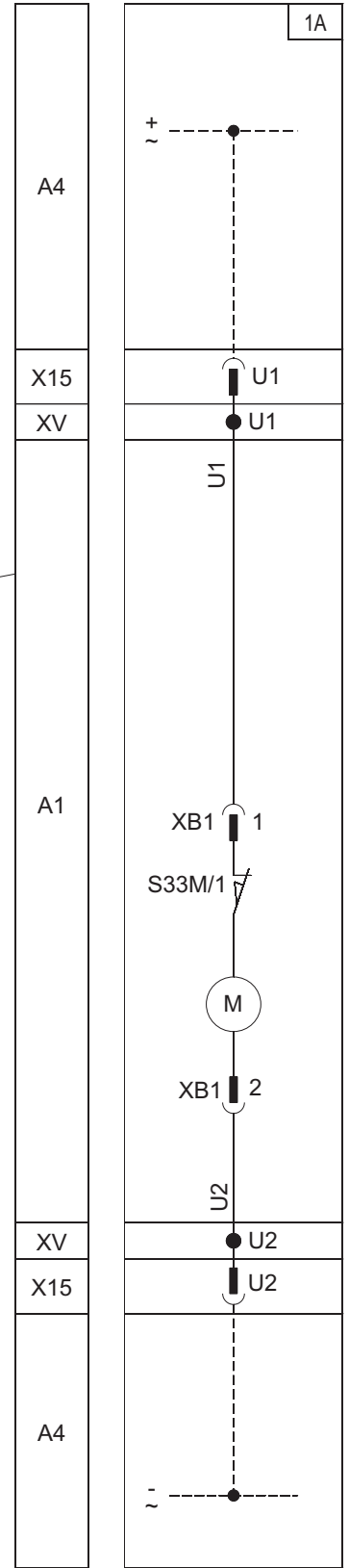
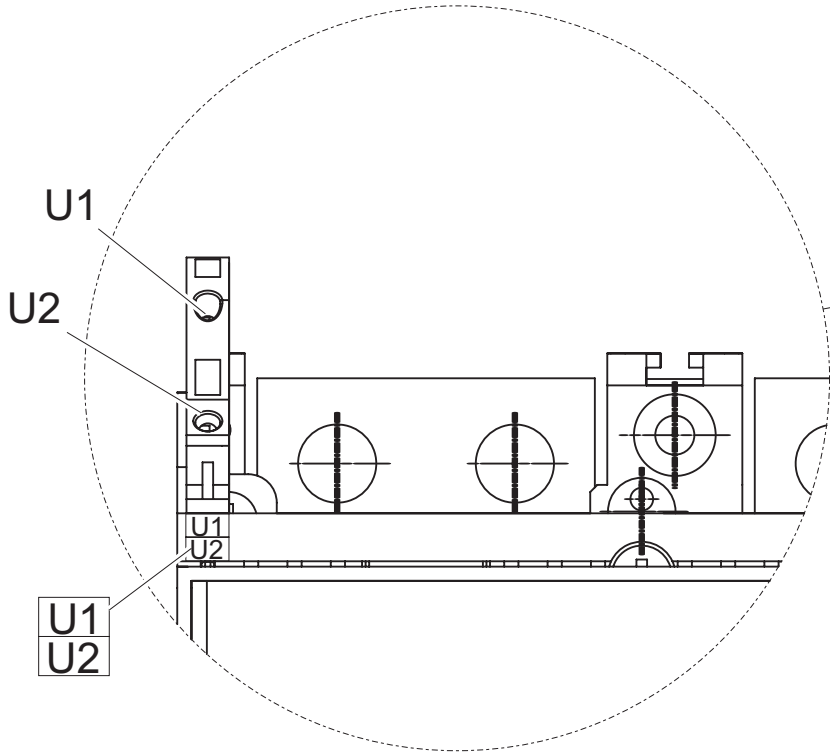

G

T7M-X1/W

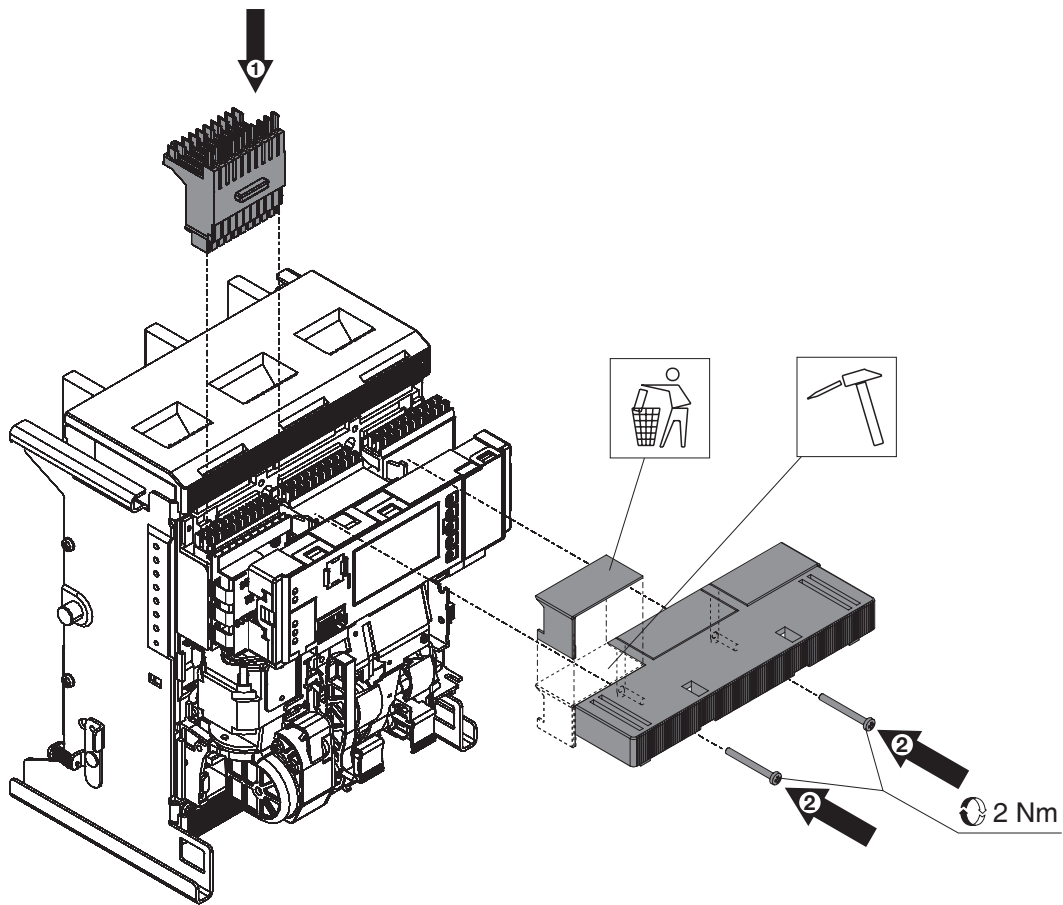

H

T7M-X1/W

